

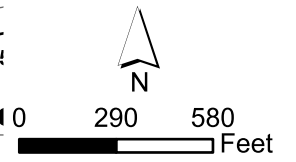

**CANADIAN LAKES
MECOSTA COUNTY, MICHIGAN
TREATMENT MAP (SHEET 1)
SURVEY DATE: MAY 9, 2024**

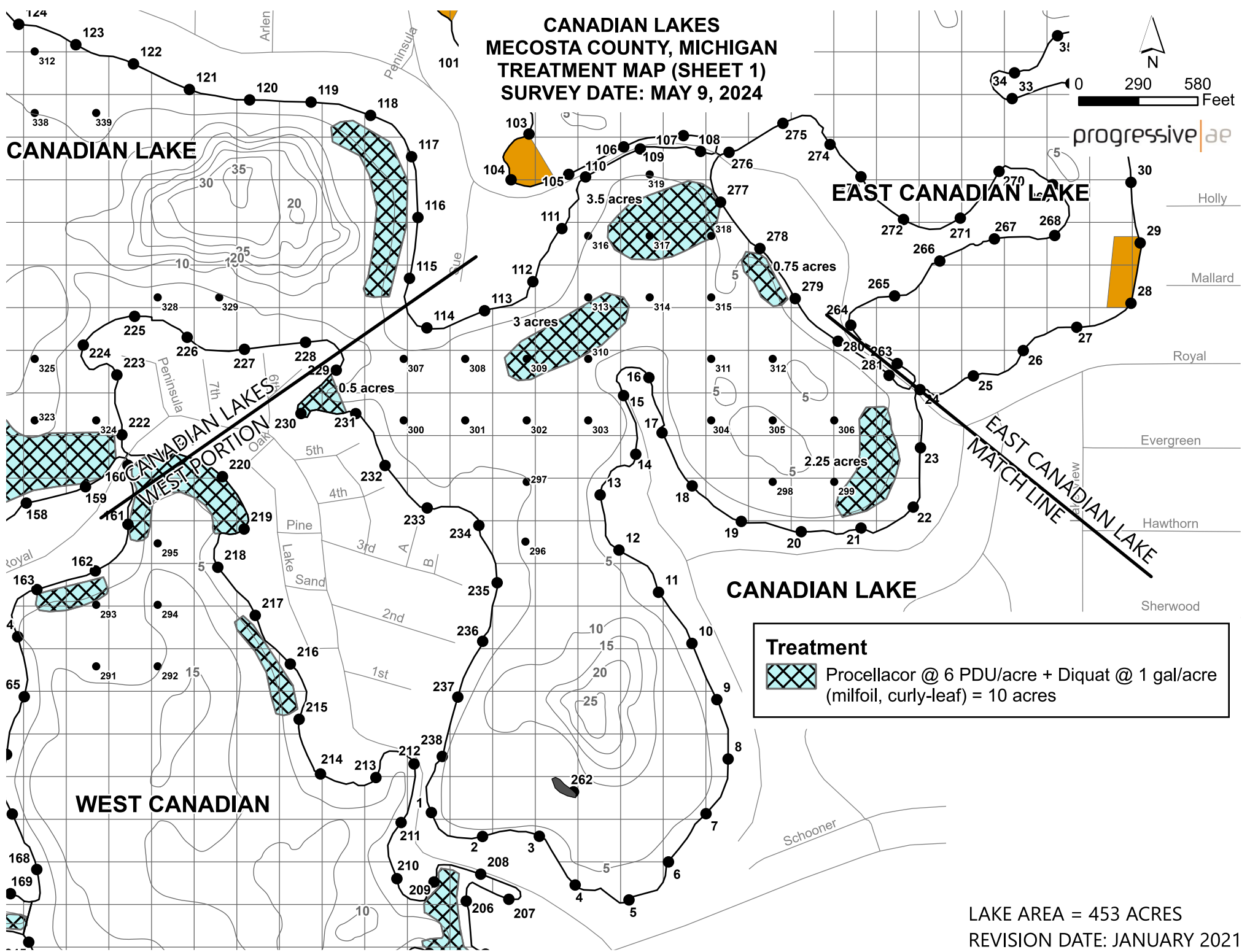

progressive|ae



Treatment

 Procellacor @ 6 PDU/acre + Diquat @ 1 gal/acre
(milfoil, curly-leaf) = 10 acres

LAKE AREA = 453 ACRES
REVISION DATE: JANUARY 2021

**CANADIAN LAKES
MECOSTA COUNTY, MICHIGAN
TREATMENT MAP (SHEET 2)
SURVEY DATE: MAY 9, 2024**

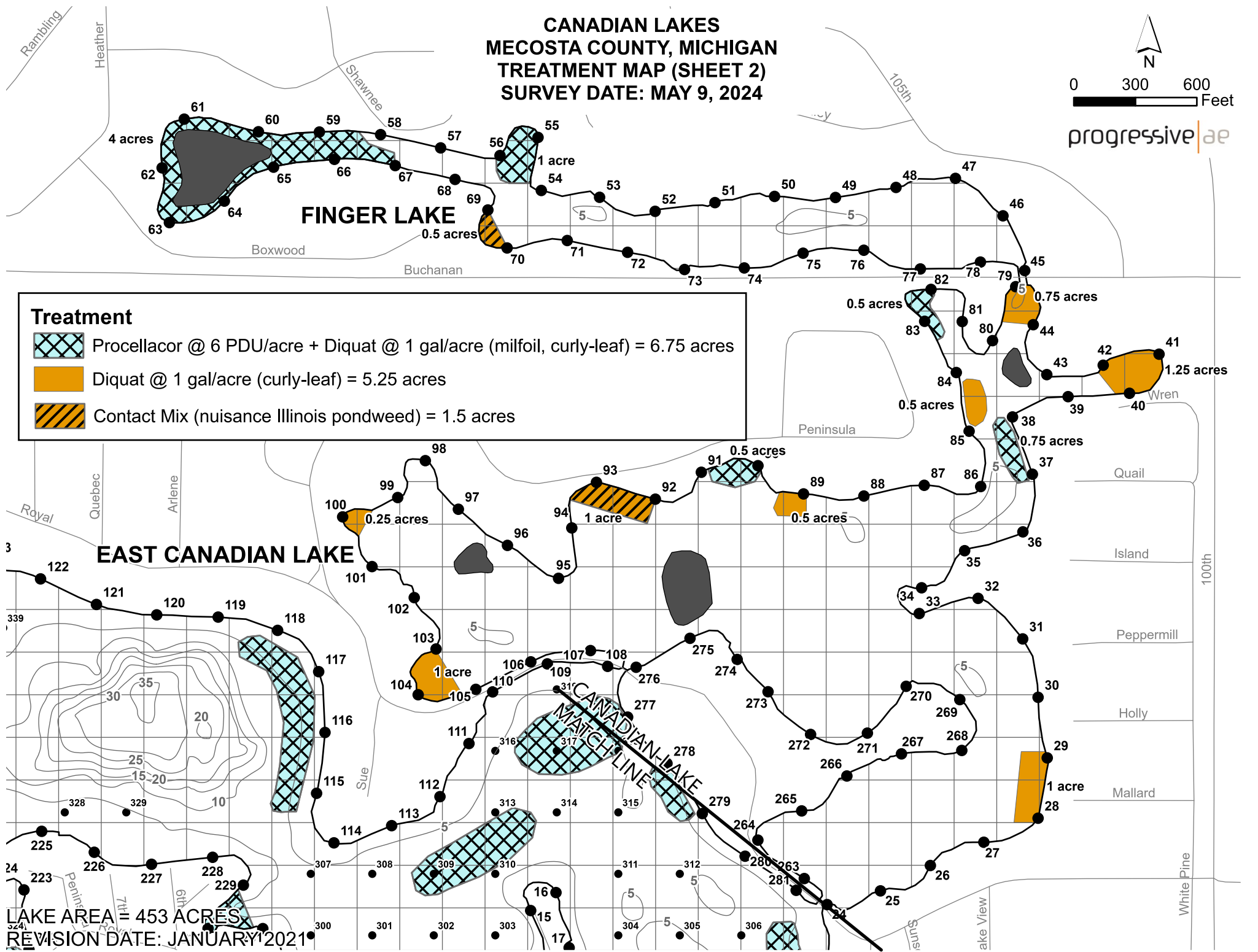
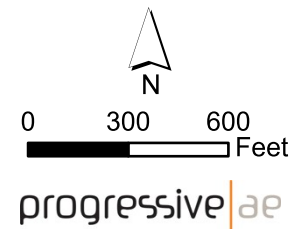

Treatment

- Procellacor @ 6 PDU/acre + Diquat @ 1 gal/acre (milfoil, curly-leaf) = 6.75 acres
- Diquat @ 1 gal/acre (curly-leaf) = 5.25 acres
- Contact Mix (nuisance Illinois pondweed) = 1.5 acres

LAKE AREA = 453 ACRES
REVISION DATE: JANUARY 2021

CANADIAN LAKES MECOSTA COUNTY, MICHIGAN TREATMENT MAP (SHEET 3) SURVEY DATE: MAY 9, 2024

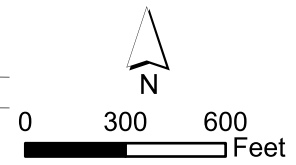

Treatment

- Procellacor @ 6 PDU/acre + Diquat @ 1 gal/acre (milfoil, curly-leaf) = 16.5 acres
- Diquat @ 1 gal/acre (curly-leaf) = 2.25 acres

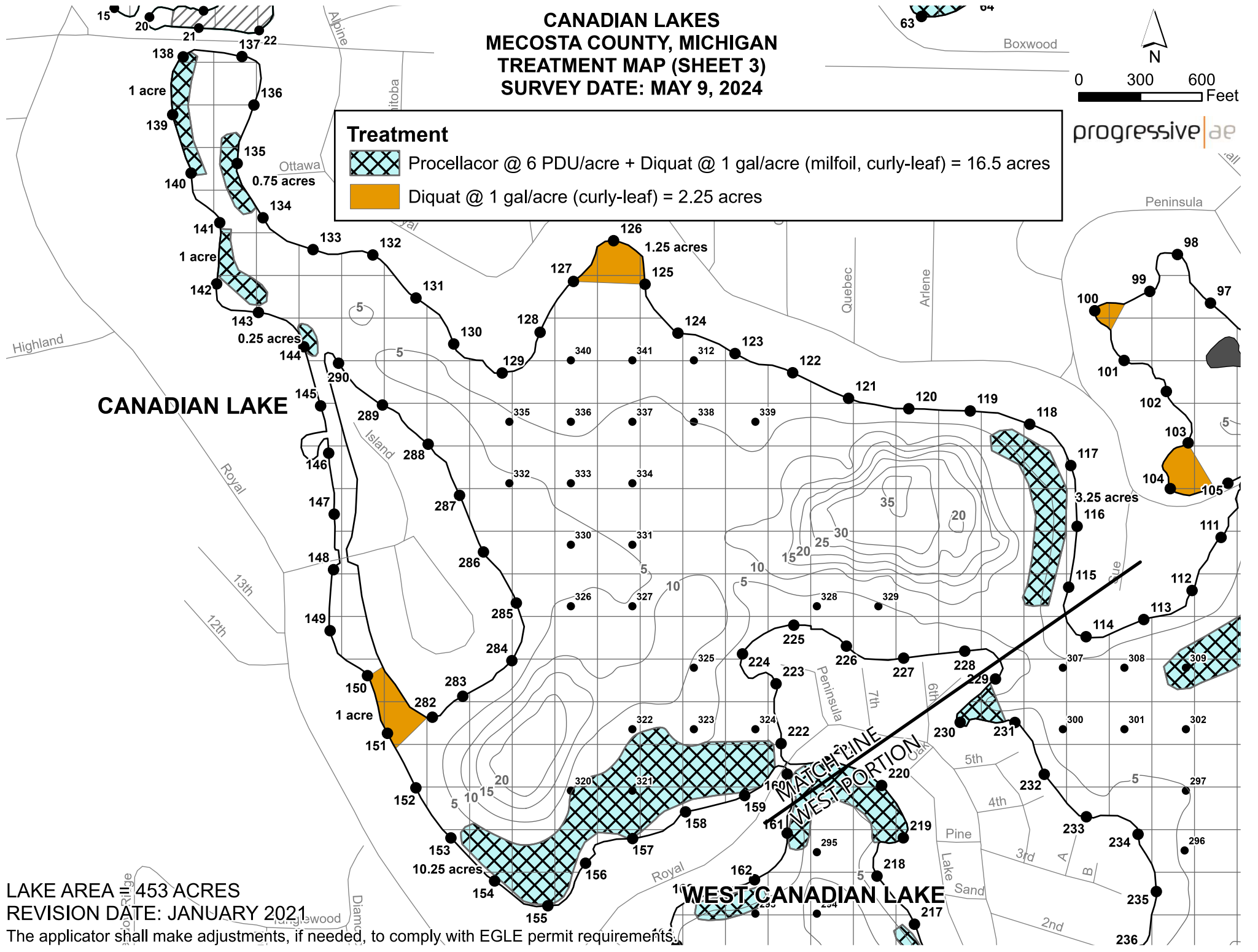

LAKE AREA 453 ACRES
REVISION DATE: JANUARY 2021

The applicator shall make adjustments, if needed, to comply with EGLE permit requirements.

progressive | ae

**CANADIAN LAKES
MECOSTA COUNTY, MICHIGAN
TREATMENT MAP (SHEET 4)
SURVEY DATE: MAY 9, 2024**

Treatment

 Procellacor @ 6 PDU/acre + Diquat @ 1 gal/acre
(milfoil, curly-leaf) = 10.75 acres

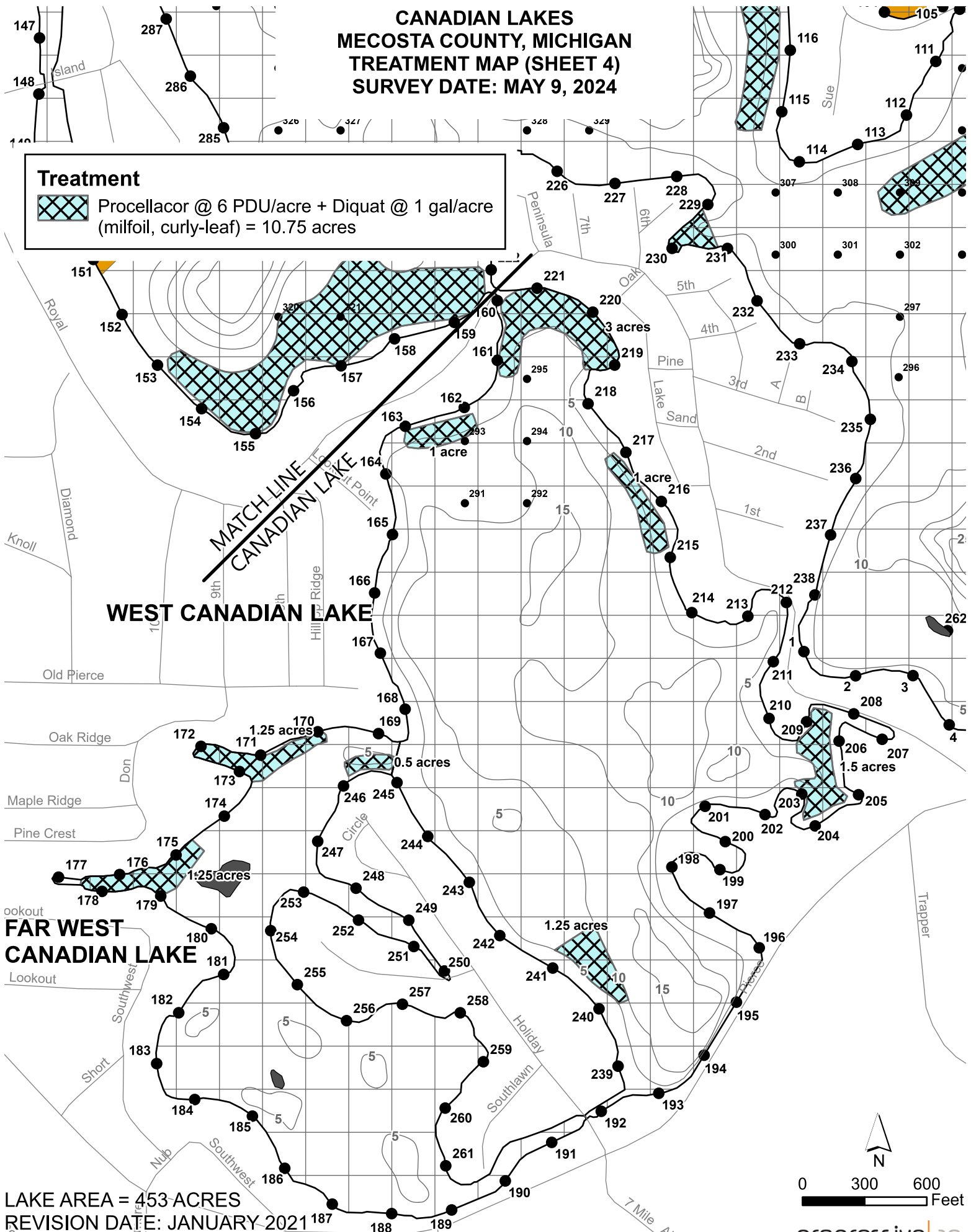

LAKE AREA = 453 ACRES

REVISION DATE: JANUARY 2021

The applicator shall make adjustments, if needed, to comply with EGLE permit requirements.

progressive|ae