

CANADIAN LAKES MECOSTA COUNTY, MICHIGAN JULY 20, 2020 TREATMENT MAP SHEET 1

1 in = 575 ft
progressive lae

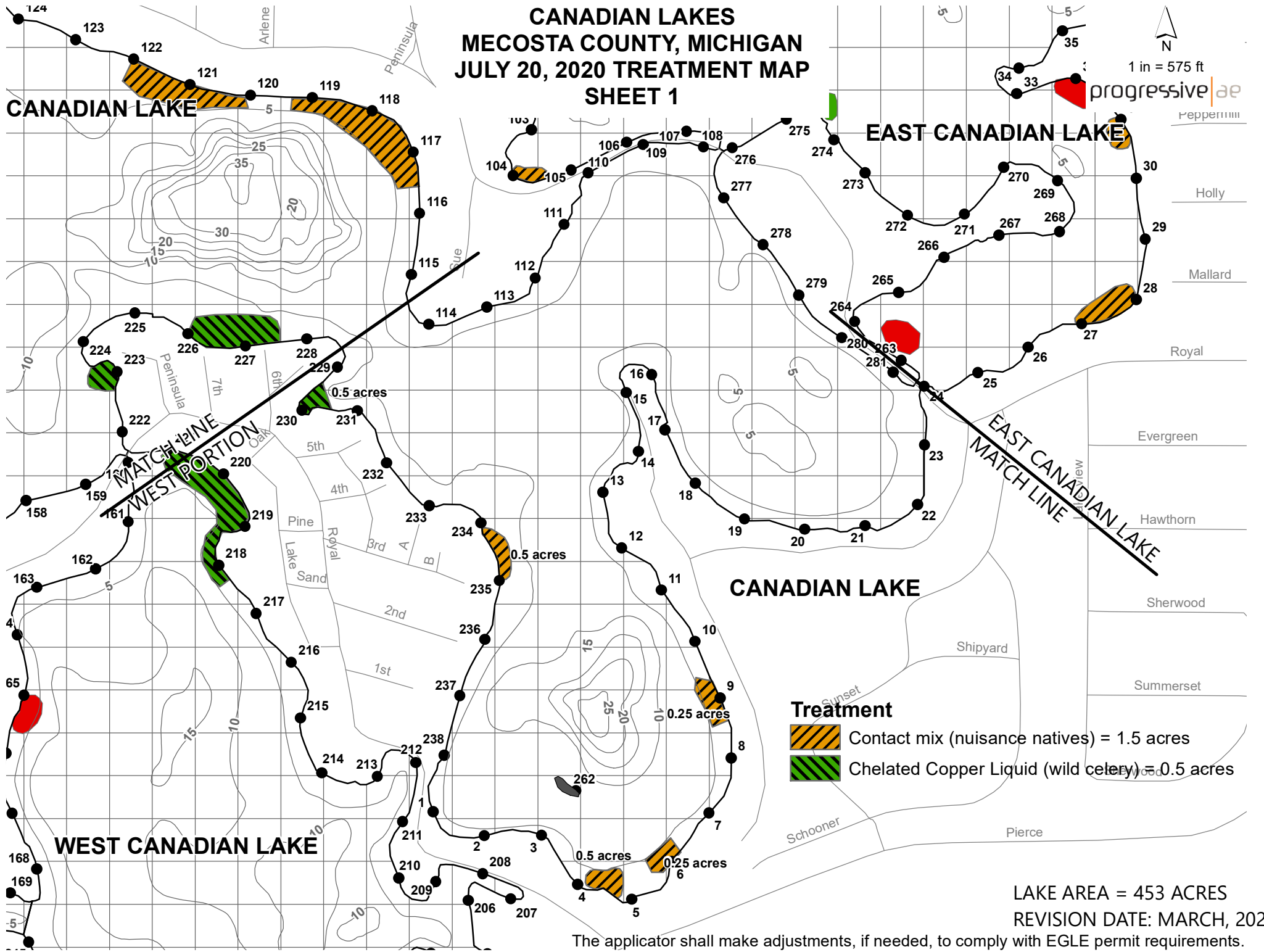

LAKE AREA = 453 ACRES
REVISION DATE: MARCH, 2020

The applicator shall make adjustments, if needed, to comply with EGLE permit requirements.

CANADIAN LAKES MECOSTA COUNTY, MICHIGAN JULY 20, 2020 TREATMENT MAP SHEET 2

1 in = 575 ft
progressive|ae

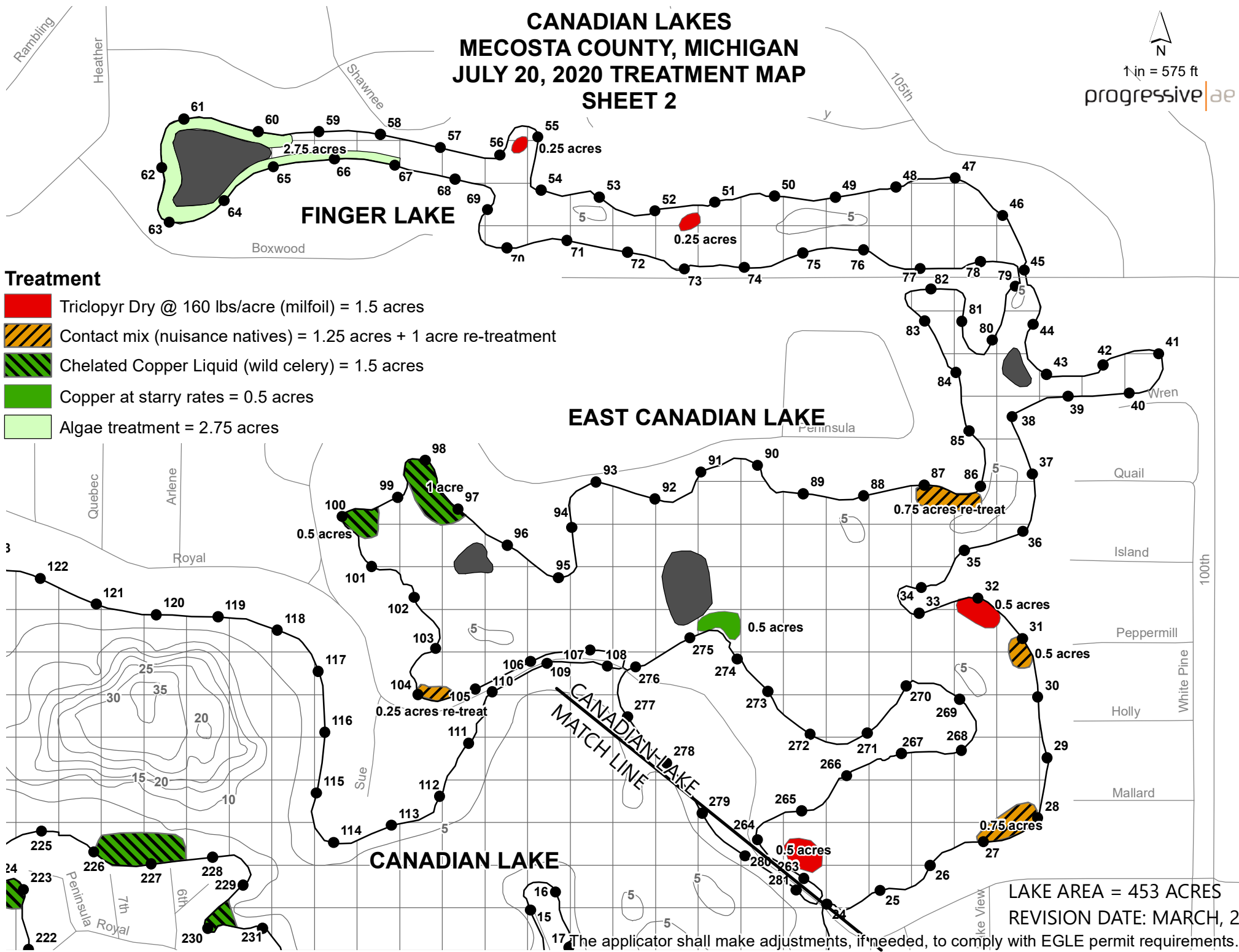

Treatment

- Triclopyr Dry @ 160 lbs/acre (milfoil) = 1.5 acres
- Contact mix (nuisance natives) = 1.25 acres + 1 acre re-treatment
- Chelated Copper Liquid (wild celery) = 1.5 acres
- Copper at starry rates = 0.5 acres
- Algae treatment = 2.75 acres

LAKE AREA = 453 ACRES
REVISION DATE: MARCH, 2020

The applicator shall make adjustments, if needed, to comply with EGLE permit requirements.

CANADIAN LAKES MECOSTA COUNTY, MICHIGAN JULY 20, 2020 TREATMENT MAP SHEET 4

Treatment

- Triclopyr Dry @ 160 lbs/acre (milfoil) = 0.75 acres
- Contact mix (milfoil, nuisance natives) = 4.75 acres
- Chelated Copper Liquid (wild celery) = 4.25 acres
- Algae treatment = 1.5 acres

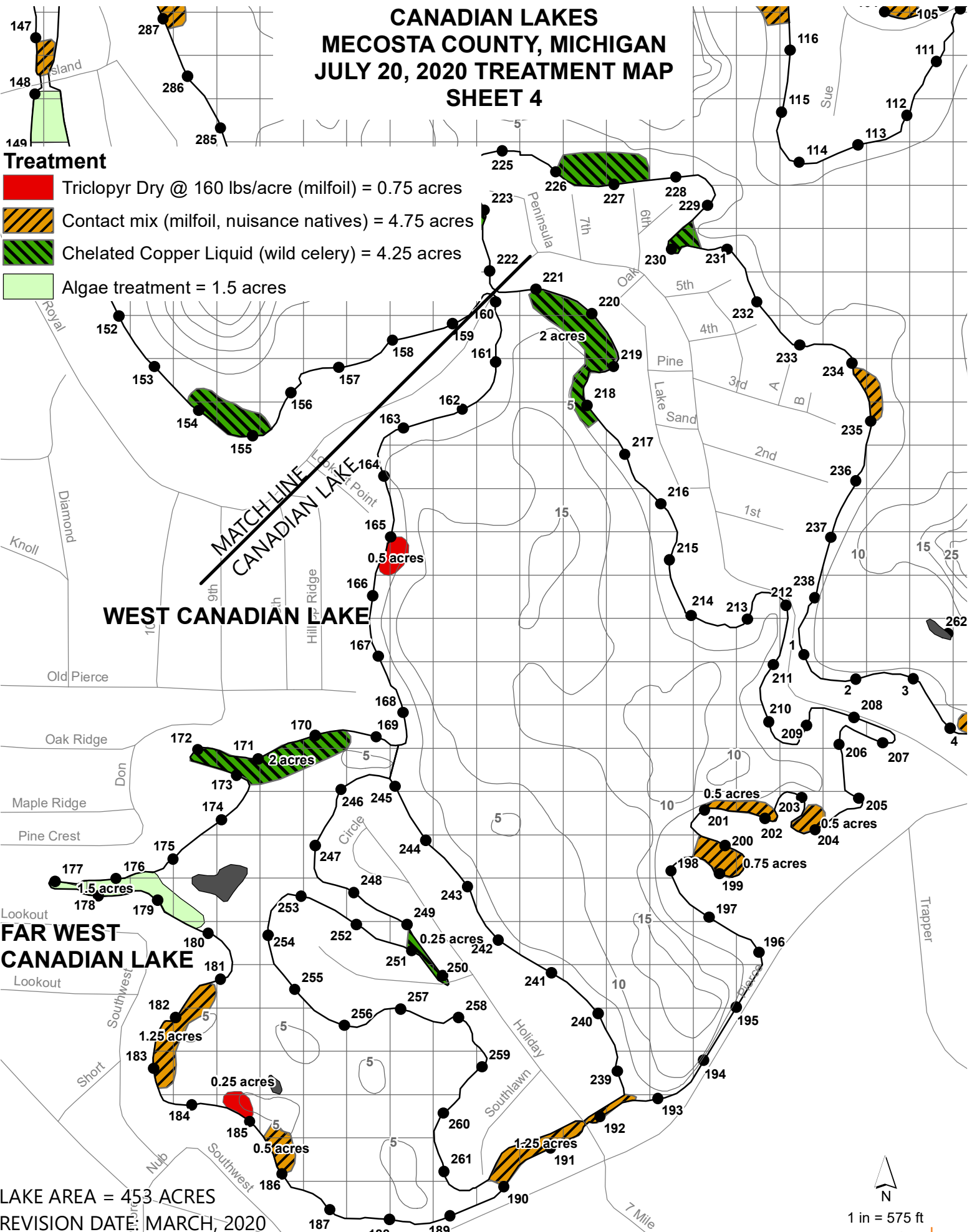

LAKE AREA = 453 ACRES
 REVISION DATE: MARCH, 2020

The applicator shall make adjustments, if needed, to comply with EGLE permit requirements.

1 in = 575 ft
progressive | a e

LAKE OF THE CLOUDS MECOSTA COUNTY, MICHIGAN JULY 20, 2020 TREATMENT MAP

= 1 ACRE

Treatment

- 2,4-D Amine @ 160 lbs/acre (milfoil) = 1 acre
- Triclopyr Dry @ 160 lbs/acre (milfoil) = 2.5 acres
- Contact mix (milfoil, nuisance natives) = 2 acres

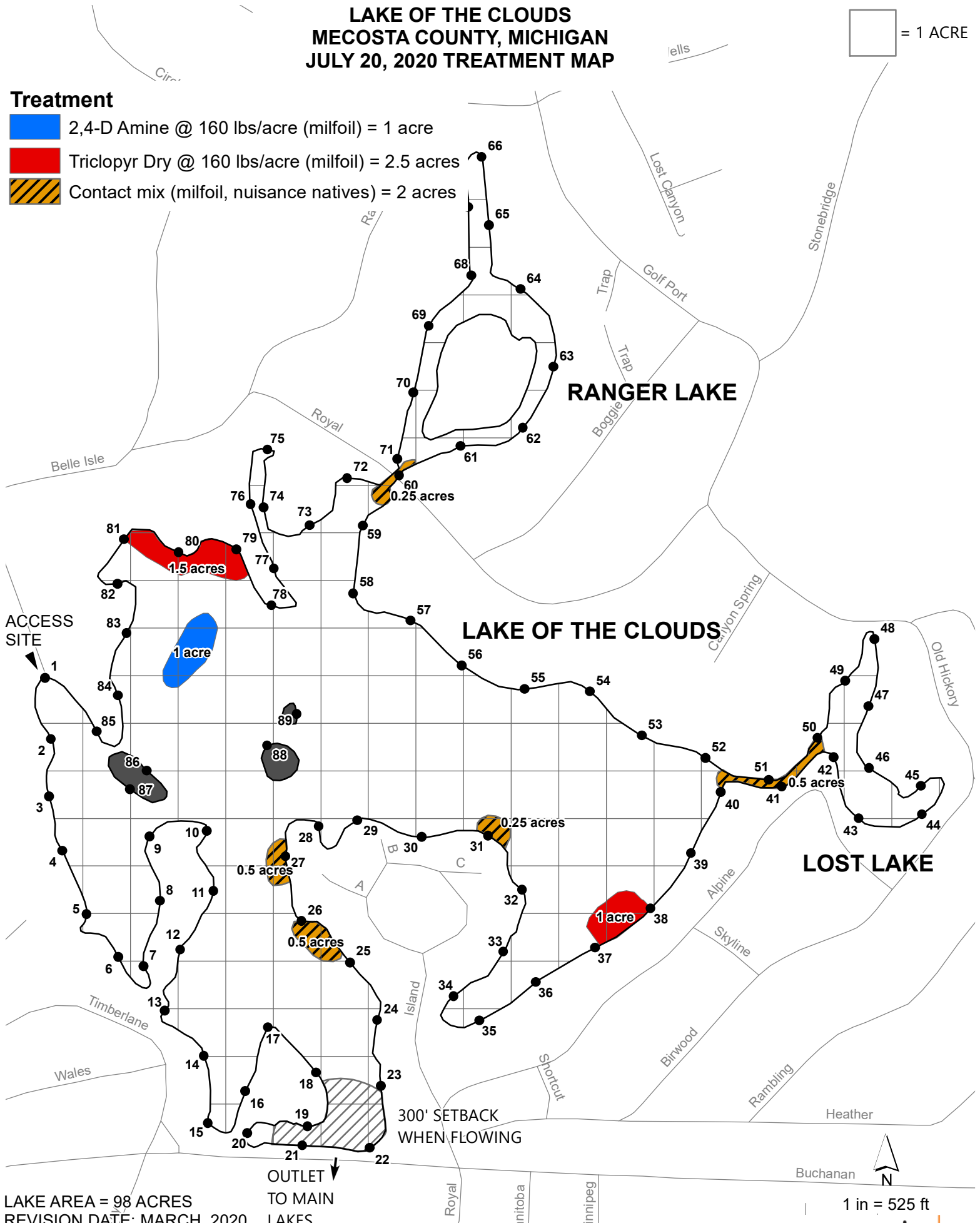

LAKE AREA = 98 ACRES
REVISION DATE: MARCH, 2020

The applicator shall make adjustments, if needed, to comply with EGLE permit requirements.

N
 1 in = 525 ft
progressive | ae

LAKE LAURA AND SUNSET LAKE MECOSTA COUNTY, MICHIGAN JULY 20, 2020 TREATMENT MAP

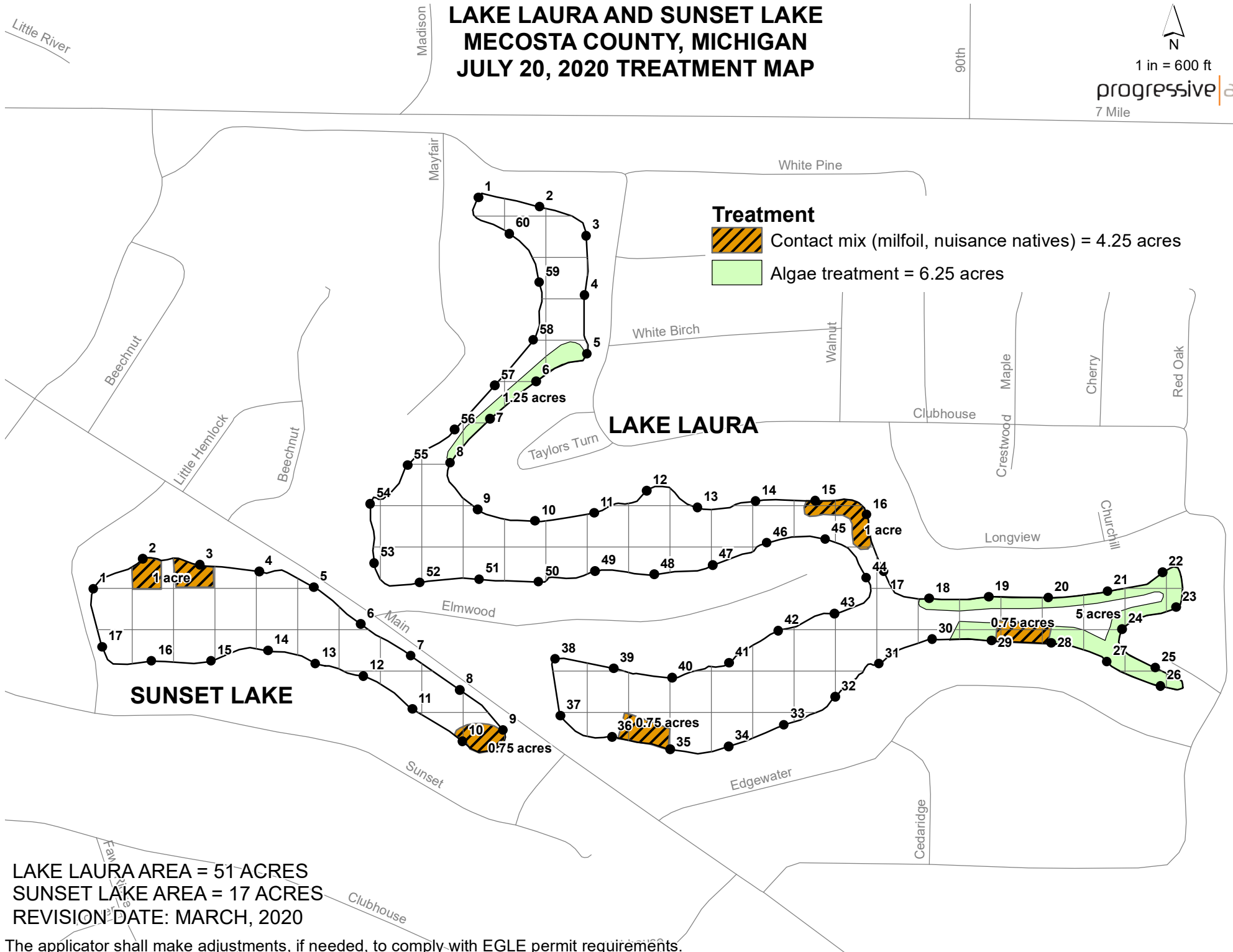

 1 in = 600 ft
 progressive | ae
 7 Mile



LAKE LAURA AREA = 51 ACRES
 SUNSET LAKE AREA = 17 ACRES
 REVISION DATE: MARCH, 2020

The applicator shall make adjustments, if needed, to comply with EGLE permit requirements.

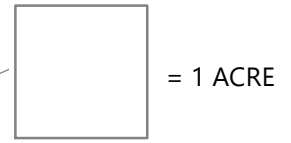
**CAMPER LAKE
MECOSTA COUNTY, MICHIGAN
JULY 20, 2020 TREATMENT MAP**



Please treat up to 6 acres of algae where necessary

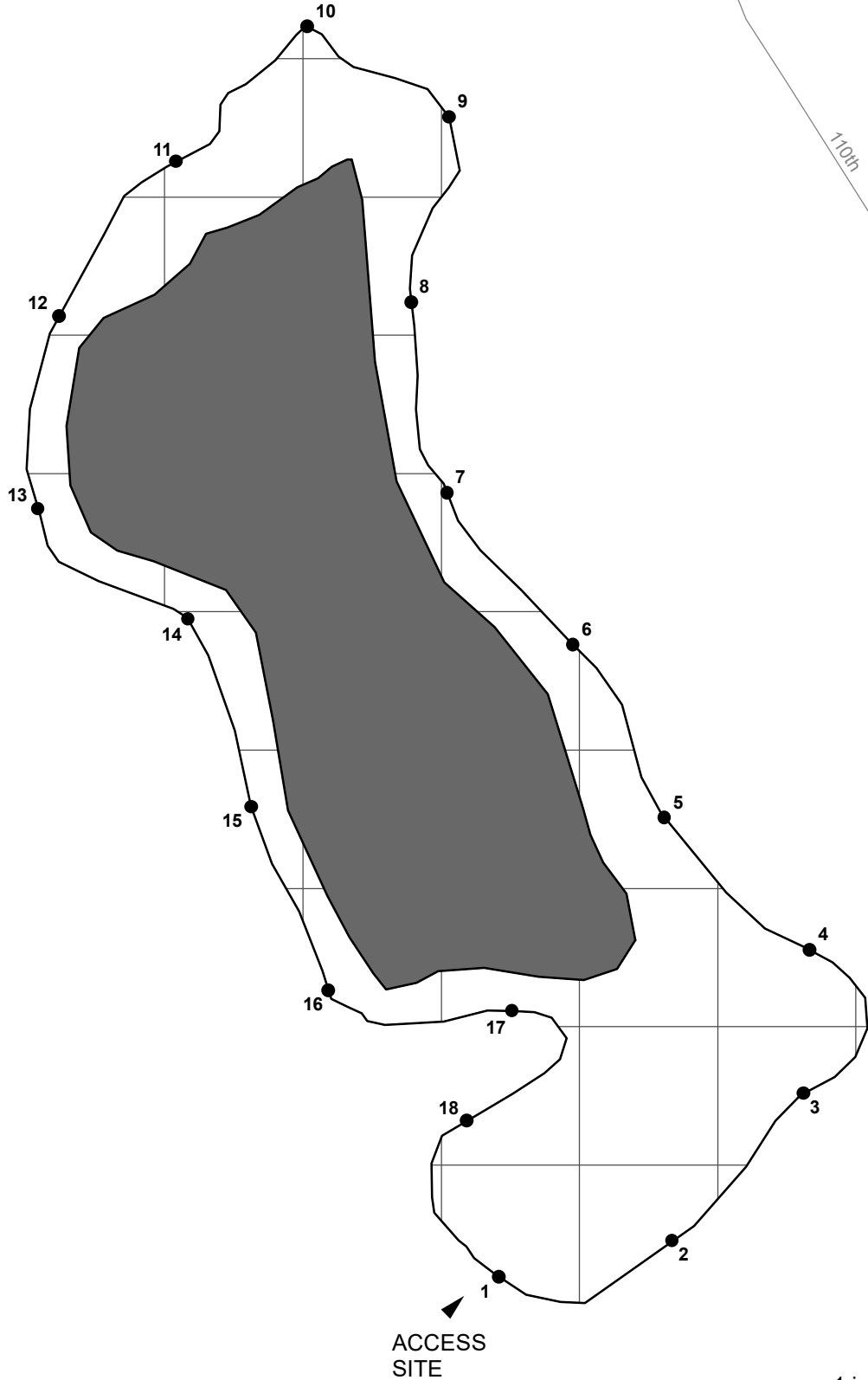

LAKE AREA = 20 ACRES
REVISION DATE: MARCH, 2020

The applicator shall make adjustments, if needed, to comply with EGLE permit requirements.

FAWN LAKE MECOSTA COUNTY, MICHIGAN JULY 20, 2020 TREATMENT MAP

Treatment

 Copper at chara rates = 3.75 acres

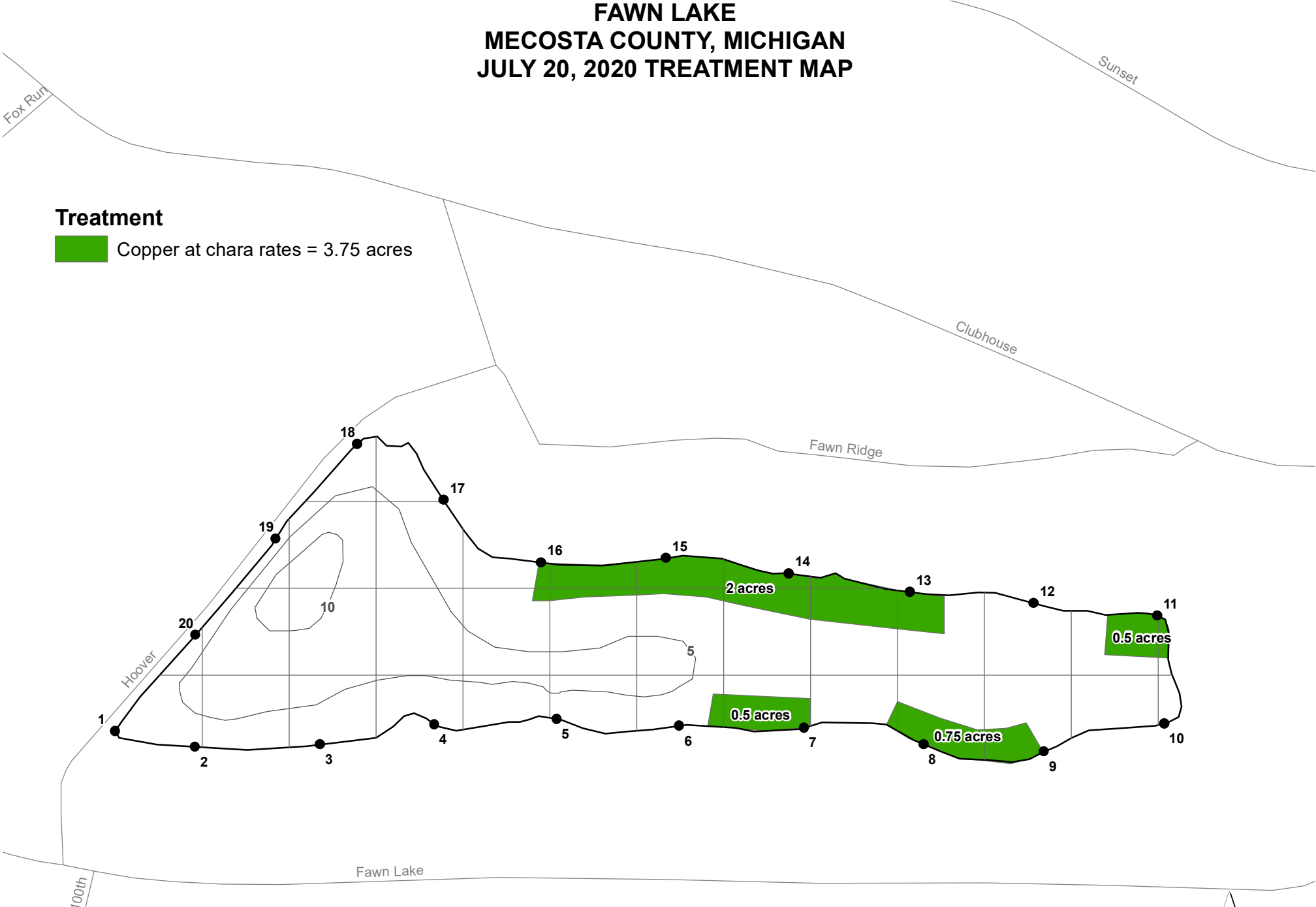

LAKE AREA = 23 ACRES
REVISION DATE: MARCH, 2020

The applicator shall make adjustments, if needed, to comply with EGLE permit requirements.

N
1 in = 300 ft
progressive | ae