

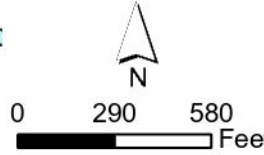

**CANADIAN LAKES  
MECOSTA COUNTY, MICHIGAN  
TREATMENT MAP  
SURVEY DATE: MAY 10, 2023  
SHEET 1**

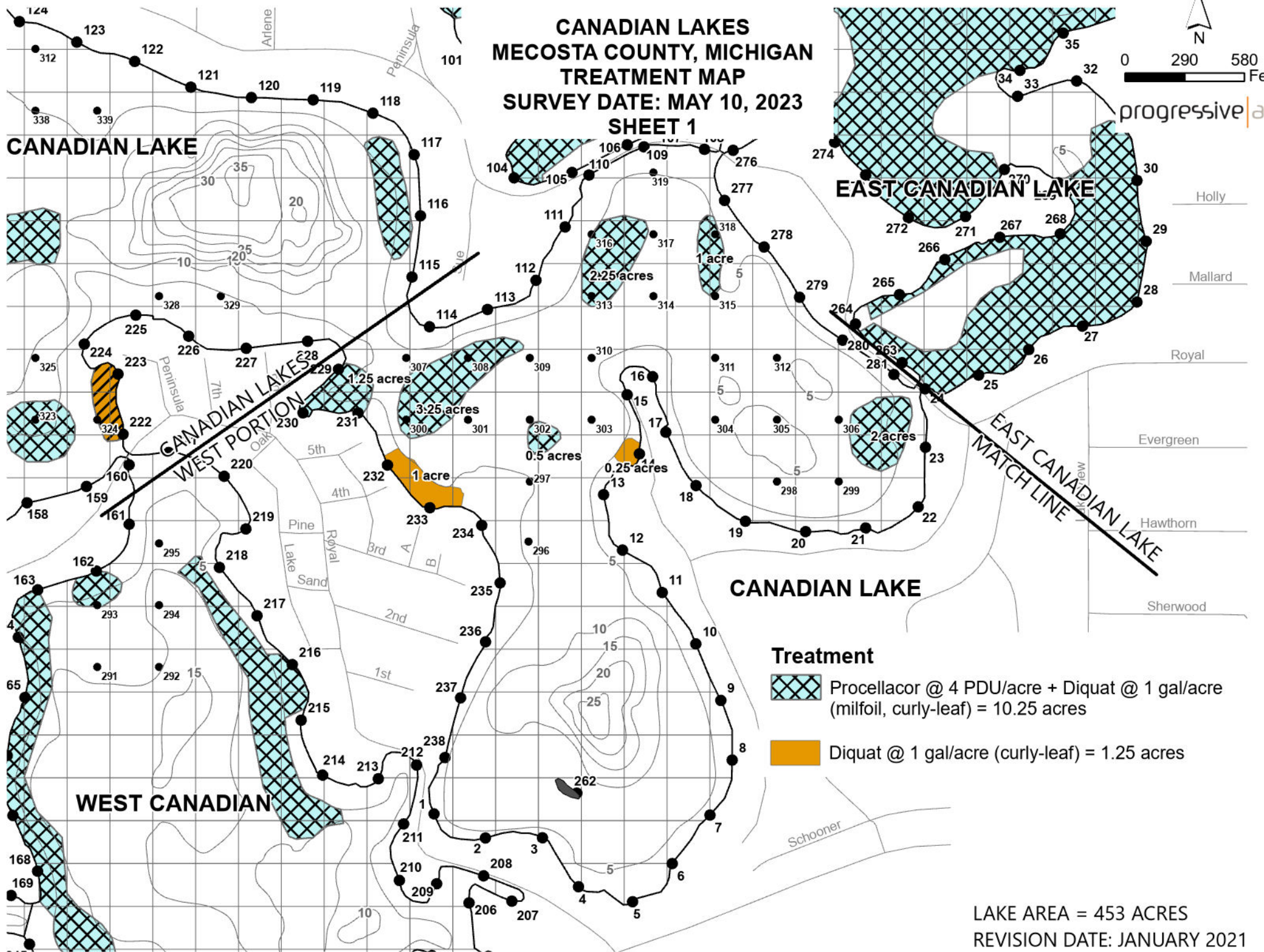

progressive|ae



- Treatment**
-  Procellacor @ 4 PDU/acre + Diquat @ 1 gal/acre (milfoil, curly-leaf) = 10.25 acres
  -  Diquat @ 1 gal/acre (curly-leaf) = 1.25 acres

LAKE AREA = 453 ACRES  
REVISION DATE: JANUARY 2021

# CANADIAN LAKES MECOSTA COUNTY, MICHIGAN TREATMENT MAP MAY 10, 2023 SHEET 2

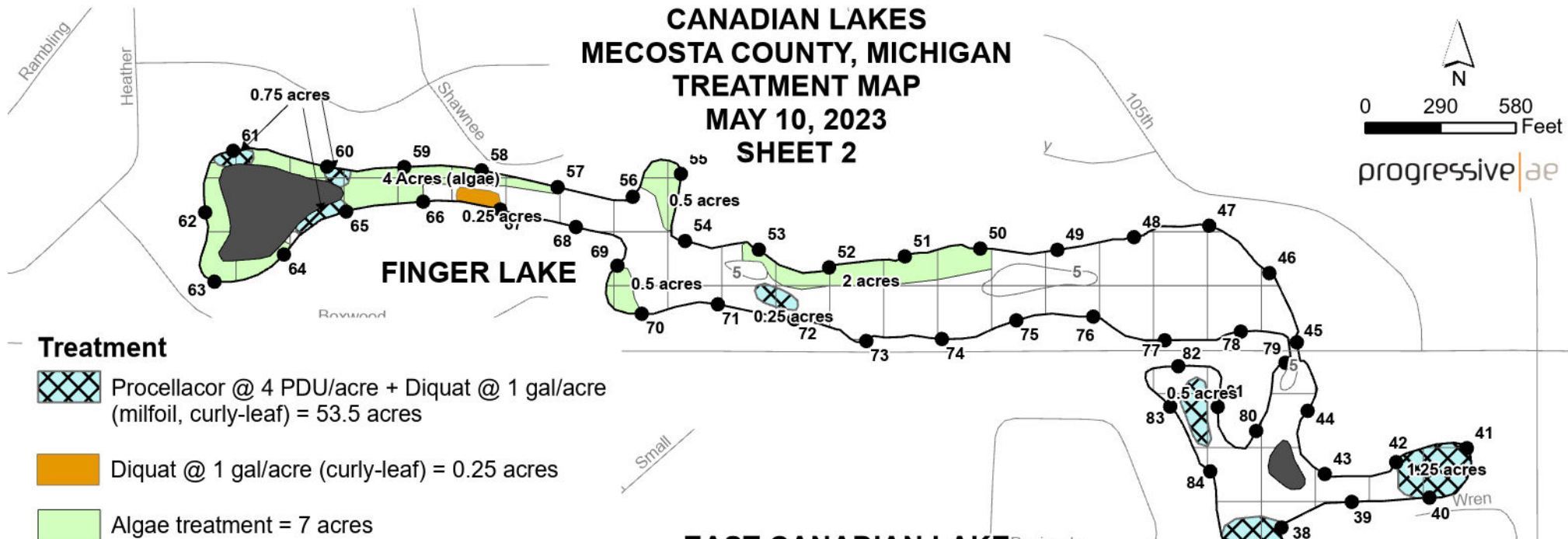
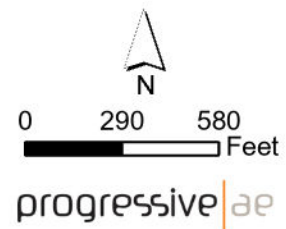

## Treatment

- Procellacor @ 4 PDU/acre + Diquat @ 1 gal/acre (milfoil, curly-leaf) = 53.5 acres
- Diquat @ 1 gal/acre (curly-leaf) = 0.25 acres
- Algae treatment = 7 acres

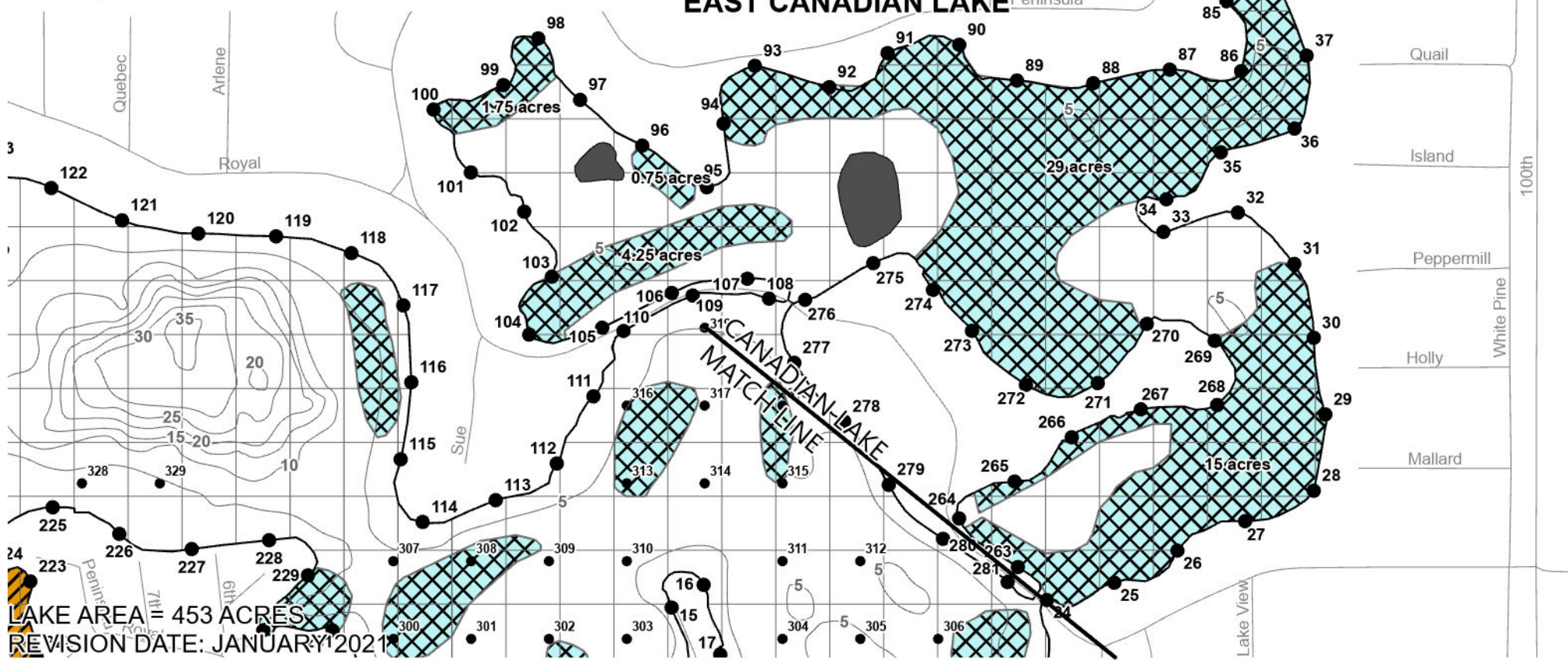

Trea



# CANADIAN LAKES MECOSTA COUNTY, MICHIGAN TREATMENT MAP SURVEY DATE: MAY 10, 2023 SHEET 4

## Treatment

 Procellacor @ 4 PDU/acre + Diquat @ 1 gal/acre (milfoil, curly-leaf) = 30.25 acres

 Algae treatment = 1.25 acres

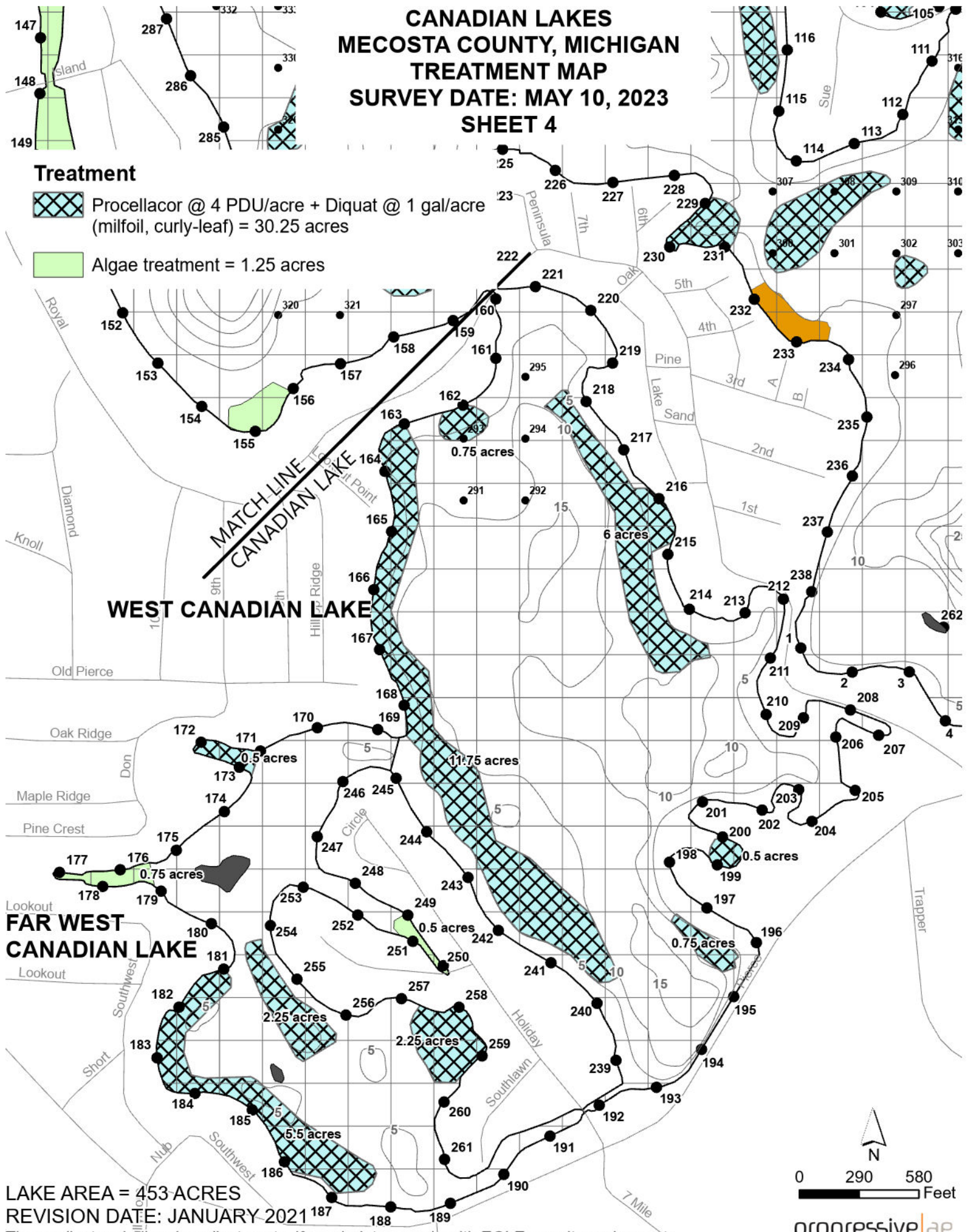

LAKE AREA = 453 ACRES

REVISION DATE: JANUARY 2021

The applicator shall make adjustments, if needed, to comply with EGLE permit requirements.

# LAKE OF THE CLOUDS MECOSTA COUNTY, MICHIGAN TREATMENT MAP SURVEY DATE: MAY 10, 2023

= 1 ACRE

## Treatment

Procellacor @ 4 PDU/acre + Diquat @ 1 gal/acre (mixed exotics) = 4 acres

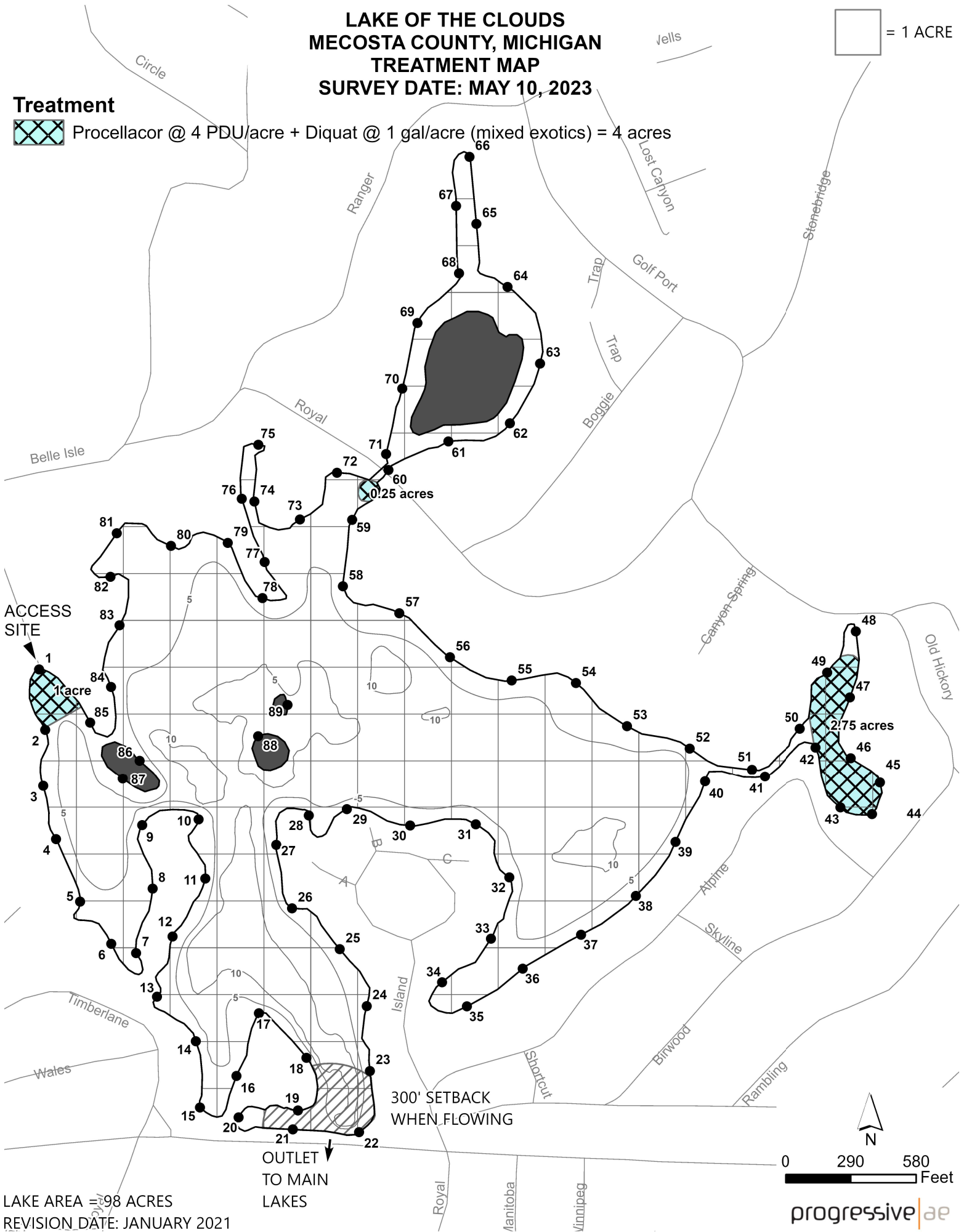

LAKE AREA = 98 ACRES  
REVISION DATE: JANUARY 2021

progressive|ae