

CANADIAN LAKES (SHEET 2) MECOSTA COUNTY, MICHIGAN TREATMENT MAP SURVEY DATE: AUGUST 9, 2023

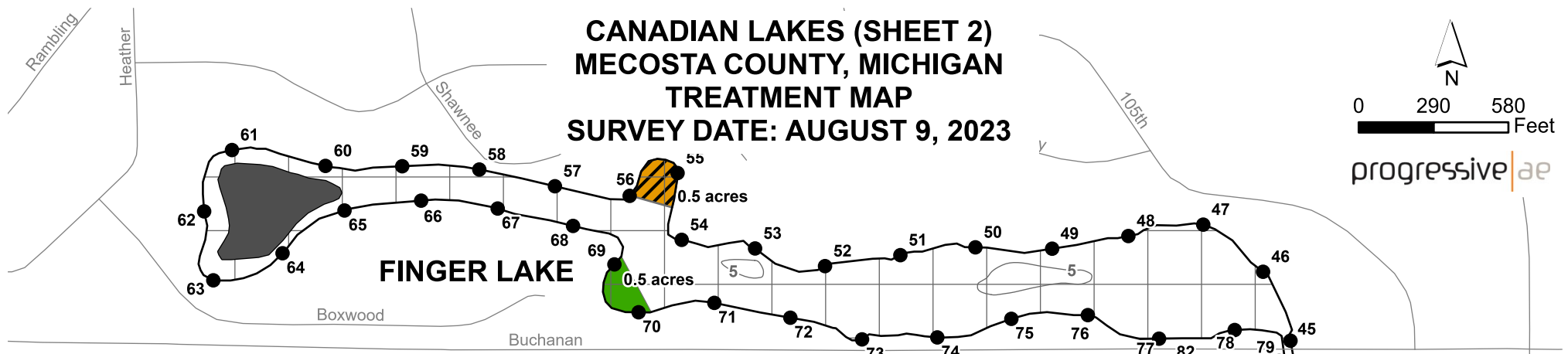

- Treatment**
- Contact mix (milfoil) = 0.5 acres
 - Copper at starry rates = 3.5 acres

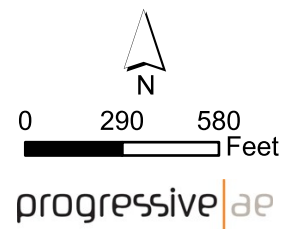
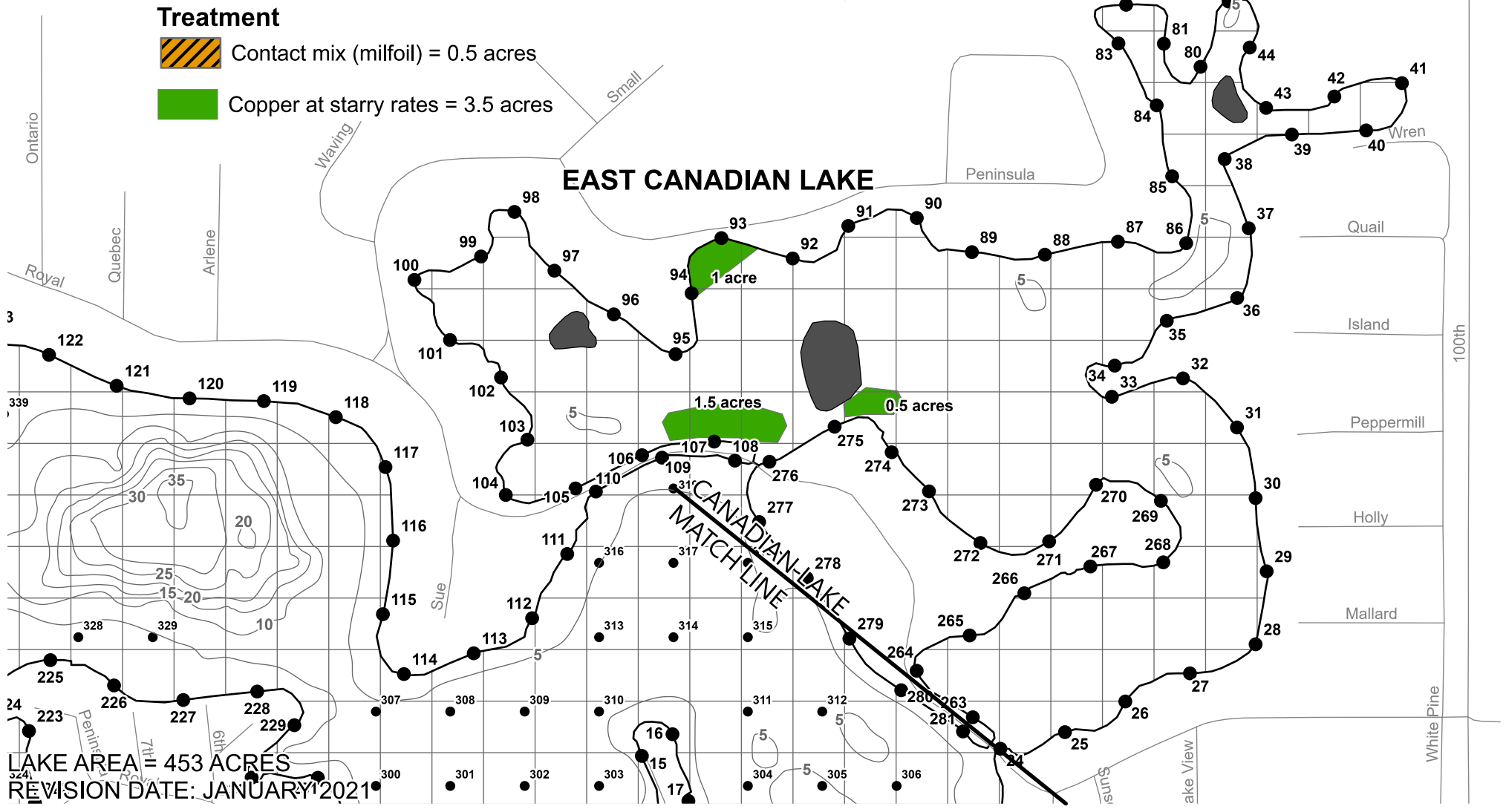

CANADIAN LAKES (SHEET 1) MECOSTA COUNTY, MICHIGAN TREATMENT MAP SURVEY DATE: AUGUST 9, 2023



0 290 580 Feet

progressive|ae

CANADIAN LAKE

EAST CANADIAN LAKE

CANADIAN LAKE

WEST CANADIAN

CANADIAN LAKES
WEST PORTION

EAST CANADIAN LAKE
MATCH LINE

Treatment

 Contact mix (milfoil) = 4.75 acres

LAKE AREA = 453 ACRES
REVISION DATE: JANUARY 2021

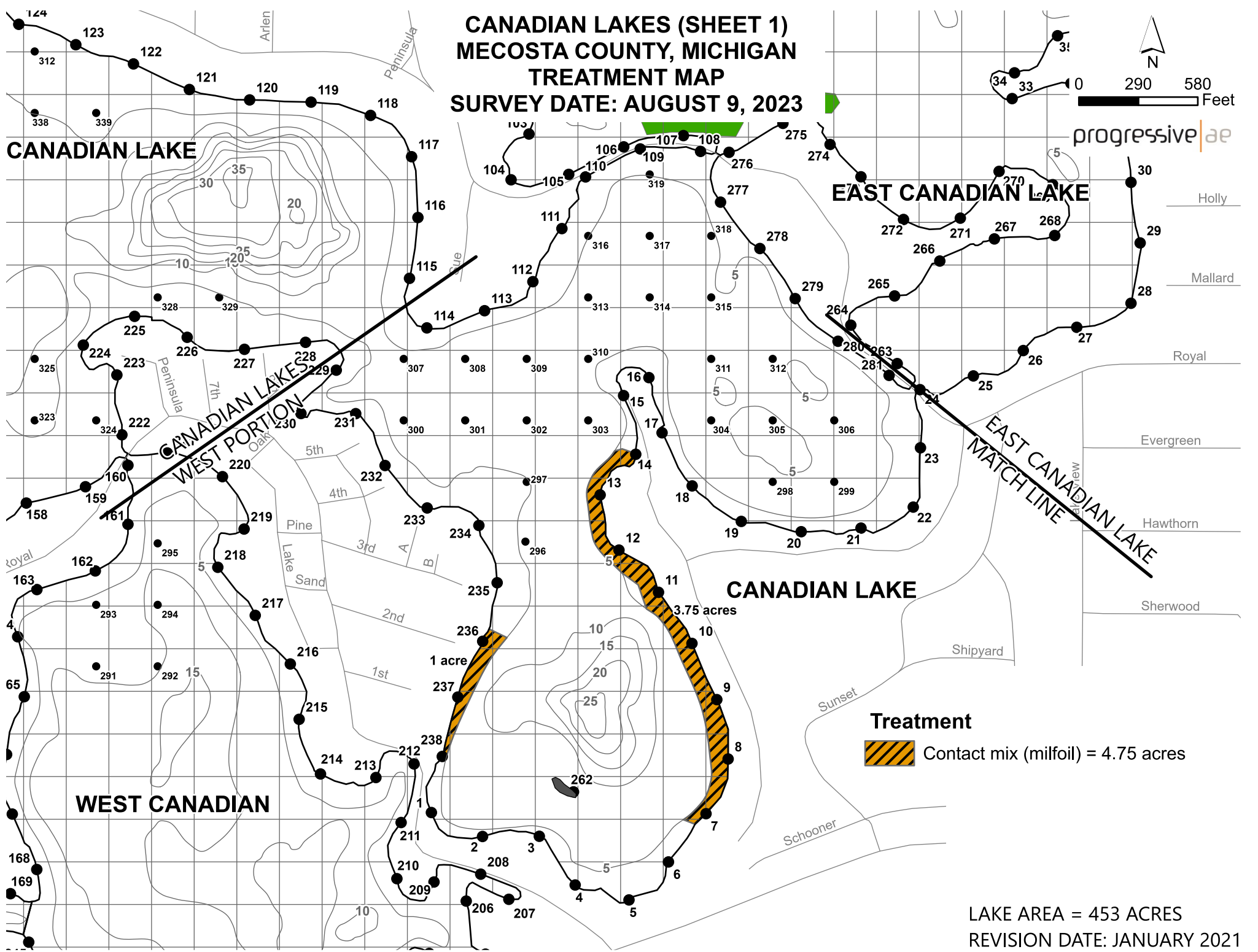

CANADIAN LAKES (SHEET 3) MECOSTA COUNTY, MICHIGAN TREATMENT MAP SURVEY DATE: AUGUST 9, 2023

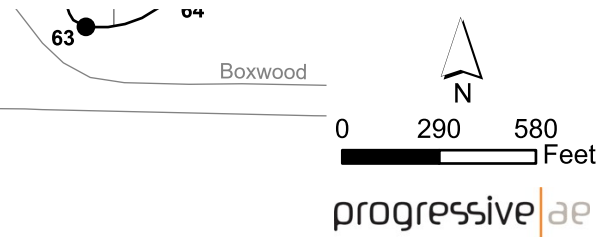

Treatment
 Copper at starry rates = 5.5 acres

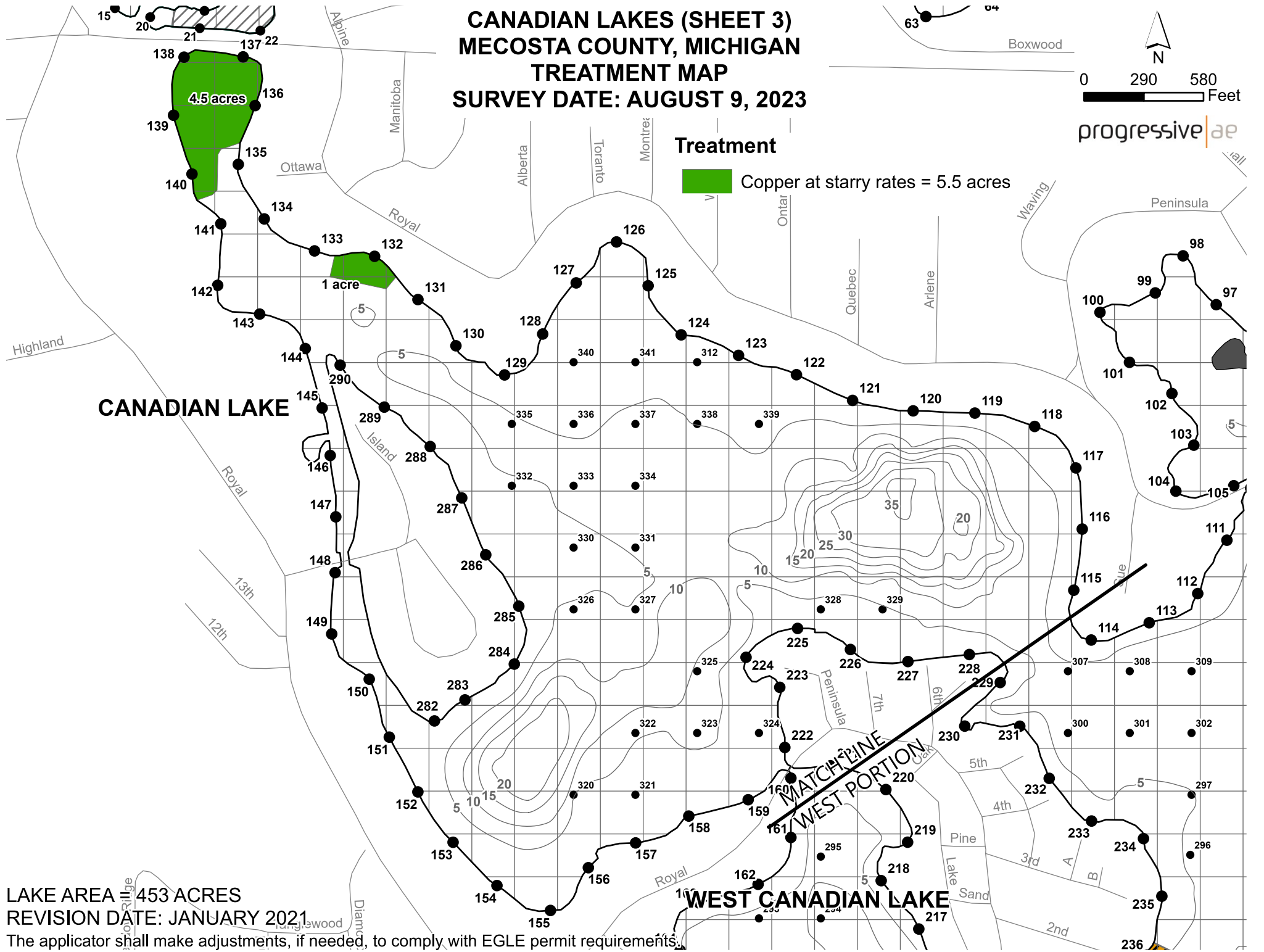

LAKE AREA 453 ACRES
 REVISION DATE: JANUARY 2021
 The applicator shall make adjustments, if needed, to comply with EGLE permit requirements.