

# CANADIAN LAKES MECOSTA COUNTY, MICHIGAN HARVEST MAP (SHEET 1) SURVEY DATE: AUGUST 5, 2024

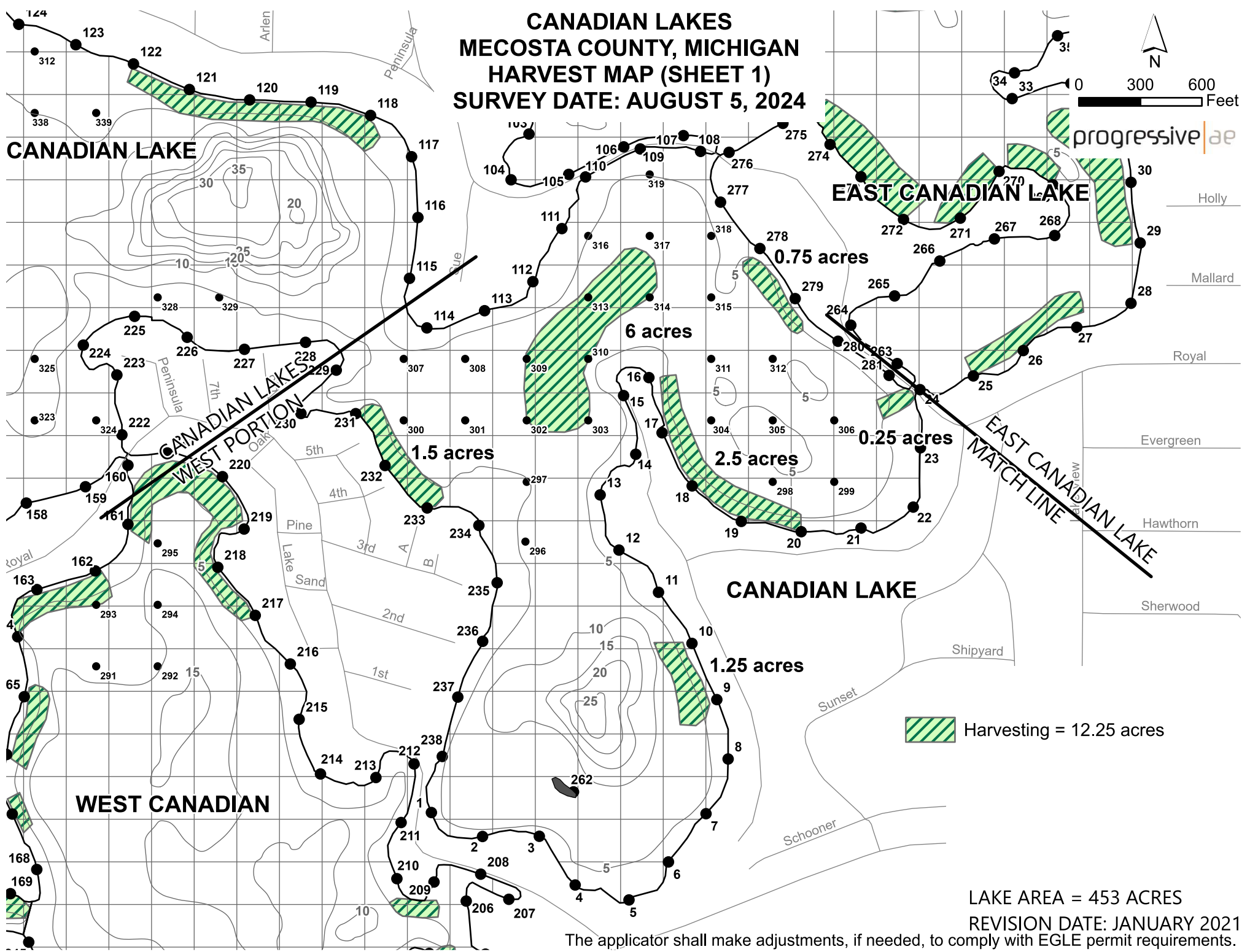
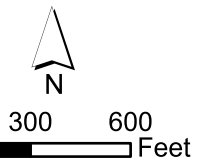

progressive | ae

LAKE AREA = 453 ACRES  
REVISION DATE: JANUARY 2021

The applicator shall make adjustments, if needed, to comply with EGLE permit requirements.

# CANADIAN LAKES MECOSTA COUNTY, MICHIGAN HARVEST MAP (SHEET 2) SURVEY DATE: AUGUST 5, 2024

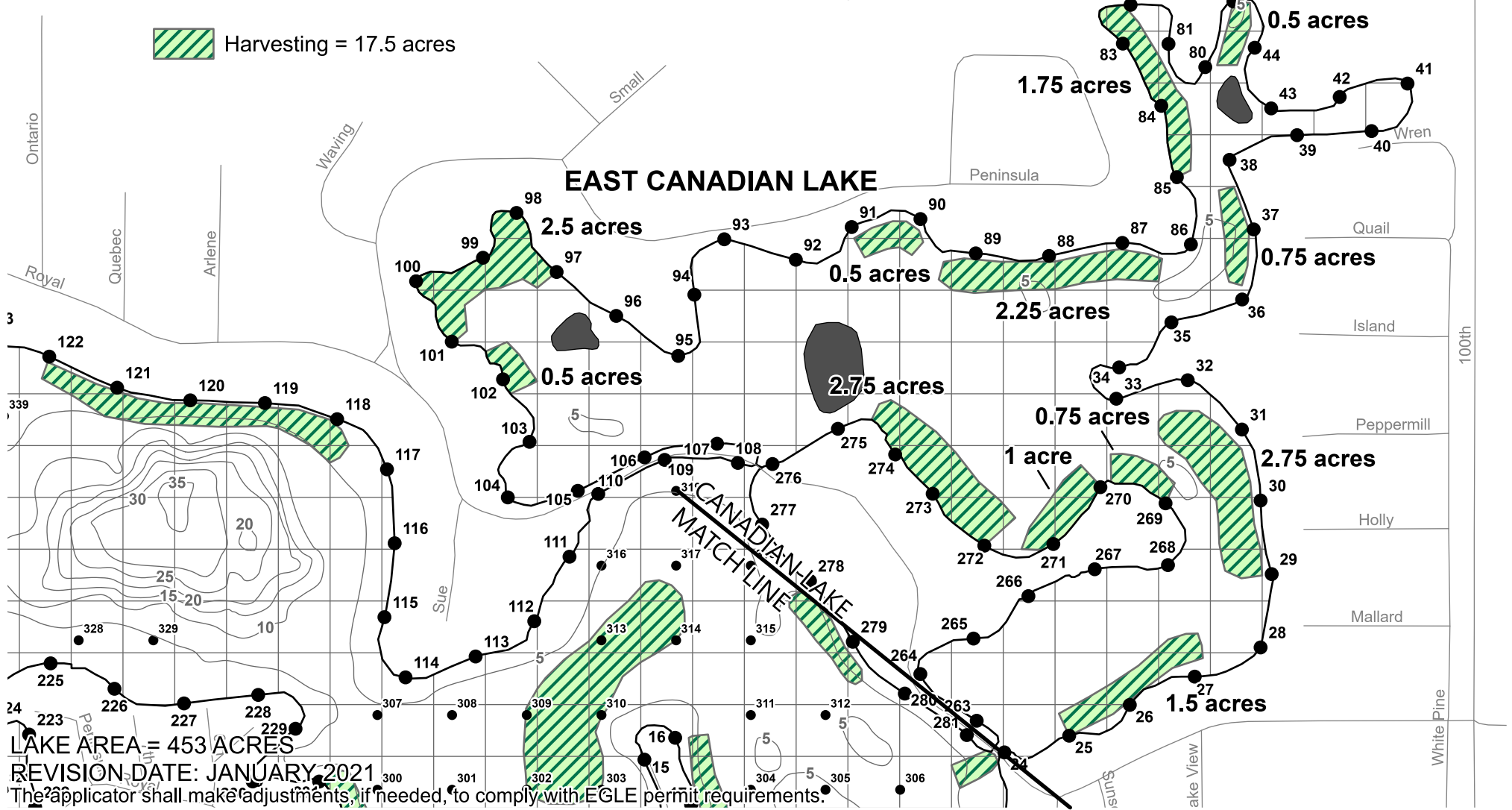
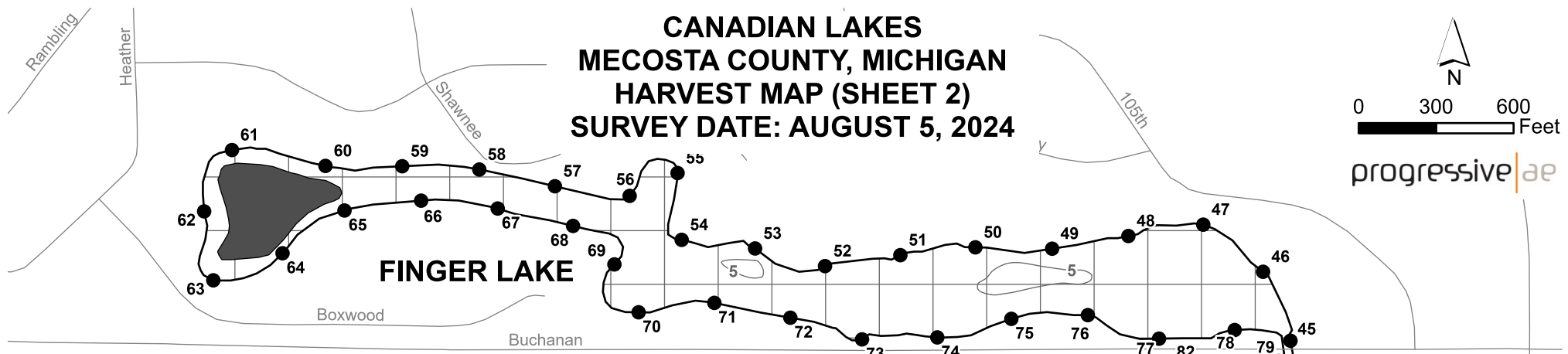
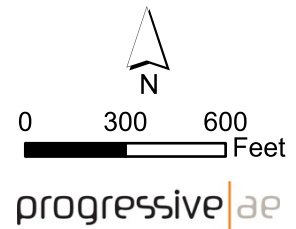

100th  
White Pine

# CANADIAN LAKES MECOSTA COUNTY, MICHIGAN HARVEST MAP (SHEET 3) SURVEY DATE: AUGUST 5, 2024

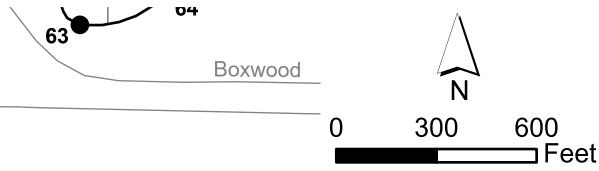

progressive|ae

 Harvesting = 4.5 acres

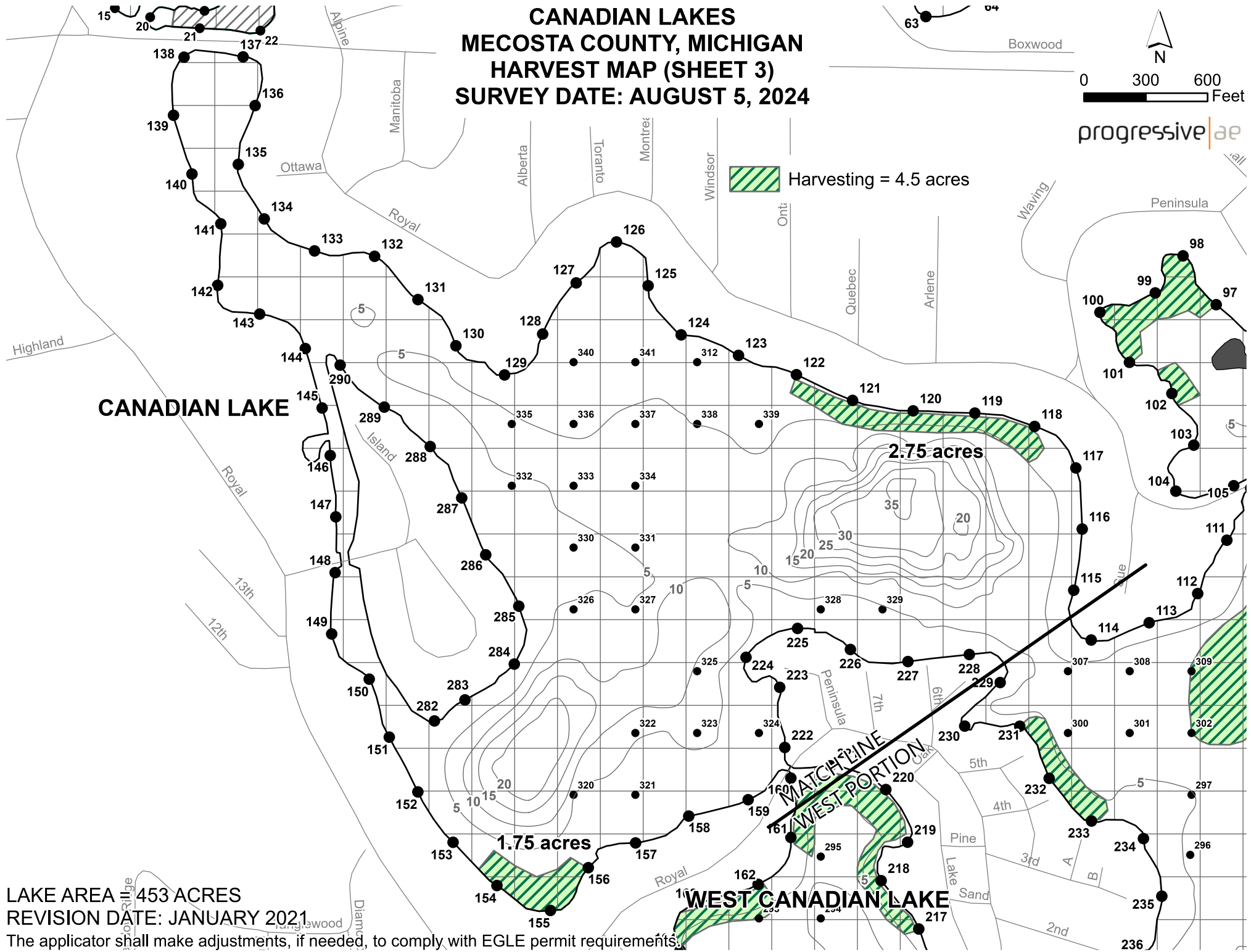

**CANADIAN LAKE**

**WEST CANADIAN LAKE**

LAKE AREA 453 ACRES  
REVISION DATE: JANUARY 2021

The applicator shall make adjustments, if needed, to comply with EGLE permit requirements.

# CANADIAN LAKES MECOSTA COUNTY, MICHIGAN HARVEST MAP (SHEET 4) SURVEY DATE: AUGUST 5, 2024

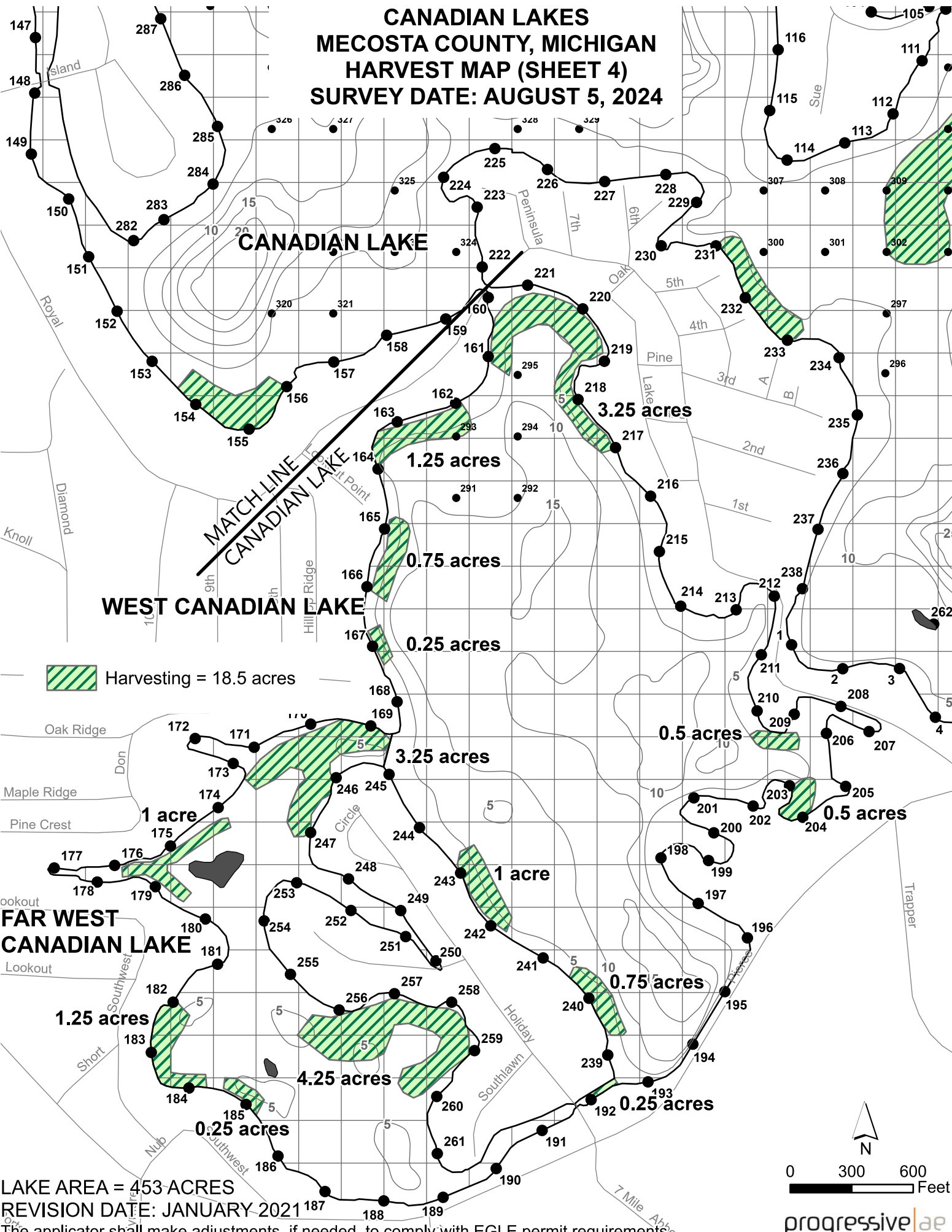

LAKE AREA = 453 ACRES  
 REVISION DATE: JANUARY 2021  
 The applicator shall make adjustments, if needed, to comply with EGLE permit requirements.

